

LC

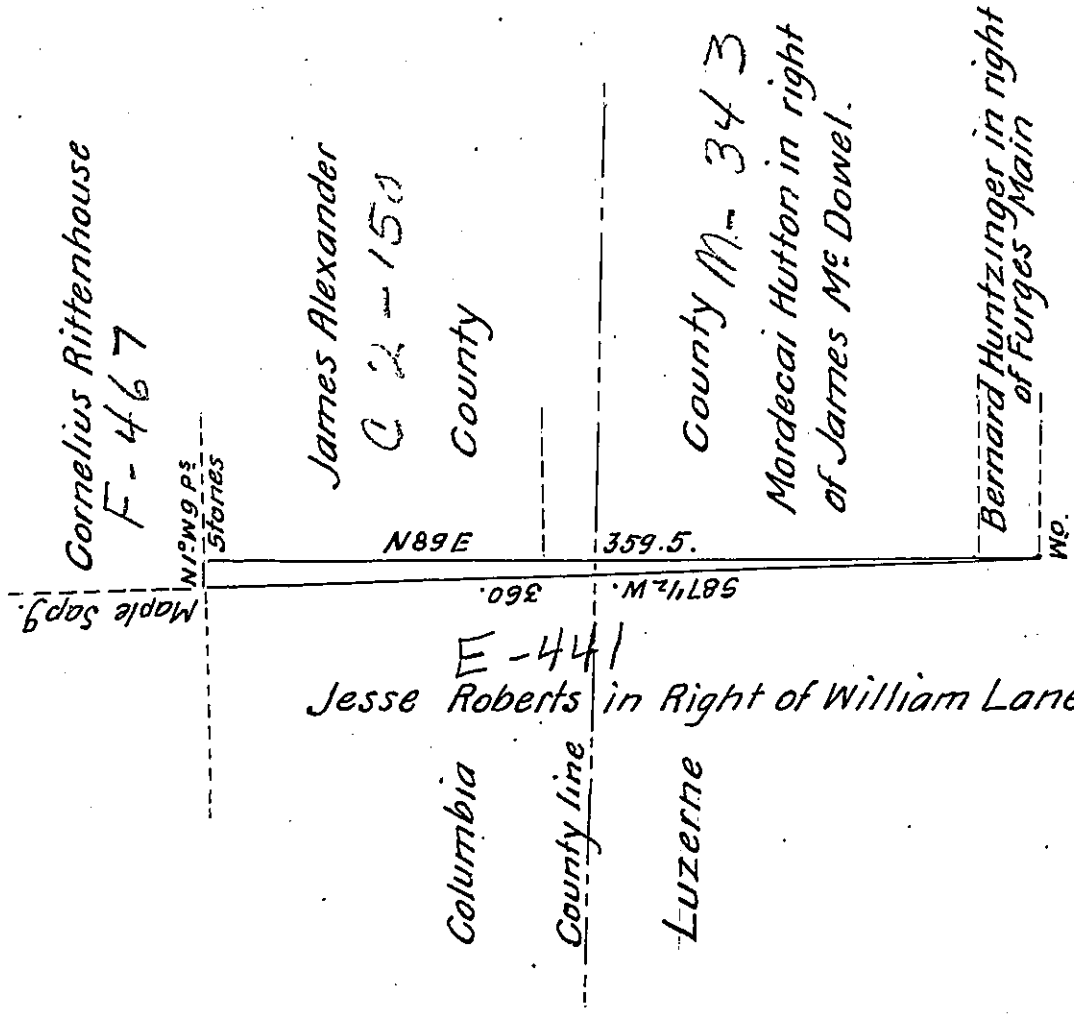

Draught of a tract of land Situate partly in Luzerne County Sugar Loaf Township and partly in Columbia County, Mifflin Township Containing nine Acres and ninety one perches of land. and the usual allowance &c. Surveyed the above described tract of land for Jesse Roberts on the 21<sup>st</sup> day of April A.D. 1825 by Virtue of his warrant dated the 14<sup>th</sup> day of August A.D. 1824.

To Gabl. Hiester Esquire }  
Surv. Genl. }

John Bennet D.S.

Joseph Prutzman D.S.

IN TESTIMONY that the above is a copy of the original remaining on file in the Department of Internal Affairs of Pennsylvania, made conformably to an Act of Assembly approved the 16th day of February, 1833, I have hereunto set my Hand and caused the Seal of said Department to be affixed at Harrisburg, this eight day of November 1906

*Isaac N. Brown*  
Secretary of Internal Affairs.